

# Catron R8D1

Wireless Rotary Smart Remote



## INSTALLATION AND QUICK START SHEET

### ⚠️ WARNING AND GUIDELINES!!!

Read and follow all safety instructions!!

**DO NOT INSTALL DAMAGED PRODUCT!** This product has been properly packed so that no parts should have been damaged during transit. Inspect to confirm. Any part damaged or broken during or after assembly should be replaced.

**WARNING: Risk of Product Damage**

- Do not disassemble the product

## PRODUCT OVERVIEW

Catron R8D1, is a rechargeable lithium battery powered rotary remote, with 4 buttons and rotary dial. It has a built-in Bluetooth module that enables it to communicate and control other devices in the Lumos Controls mesh network. This remote can be custom configured using Lumos Controls mobile app to control the brightness, color temperature of the light source and invoke scenes and control animations. This elegant and easy to use rotary remote can be mounted on a table to control the system effortlessly.



Specifications	Value	Remarks
Power supply	Rechargeable lithium battery	5V/1A Adaptor (C-type)
Operating temperature	0 to 40°C (32 to 104°F)	-
Storage temperature	-10 to 50°C (14 to 122°F)	-
Relative humidity	10% to 90%	Non-condensing
Frequency range	2402-2480MHz	-
Transmit power	8dBm	-
Receive sensitivity	-95dBm	-
Dimension	66x67.4mm(2.59 x 2.63in)	-
Weight	800g(28.2oz)	-



Like a paper weight, simply place this rotary remote on a favorite area on your desk or workspace from where you'd like to control the lighting ecosystem.

## COMMISSION THE REMOTE

Long press the top button for at least 5 seconds to bring the remote under commissioning mode, and the indicator lights on the remote will remain ON. Remote can now be added to a network and configure the functions to each button, and dial using Lumos Controls mobile application.



## CONFIGURE FUNCTIONS & CONTROL

Once commissioned, the remote can be configured with the required functionalities from 'Switch configuration' page within the 'Device settings' via mobile application. Device can be configured with 8 functions, 4 functions to the dial and 1 function each to the 4 buttons.

TARGET	ACTIONS
Favorite luminaire	ON, OFF, Intensity (up & down), CCT (up & down)
Group	ON, OFF, Intensity (up & down), CCT (up & down)
Scene	ON
Scene animation	Play, Stop, Pause, Next, Previous

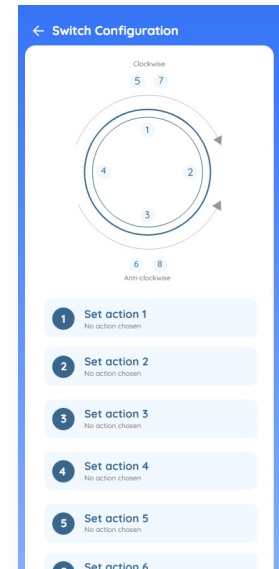

## PUSH BUTTONS

Buttons 1-4 can be used to configure the following functions of required targets.

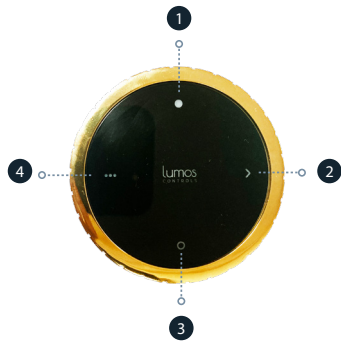

Pressing button 1-4 will control the configured function, and the corresponding button indicator light will flash once.

## ROTARY DIAL

For better experience, configure the intensity and CCT control of required targets

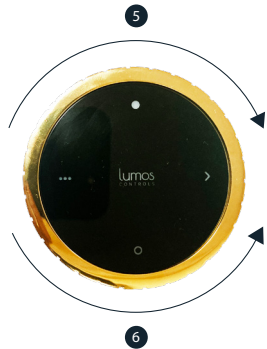

Rotate the dial clockwise to activate function 5

Rotate the dial anti-clockwise to activate function 6

Double click button 2 will flash indicator light twice, and rotate the dial to activate the functions 7 and 8

Rotate the dial clockwise to activate function 7

Rotate the dial anti-clockwise to activate function 8

The backlights flashes by clockwise or anticlockwise sequence when rotated



10 secs of non-operation will automatically bring the functions back to 5 and 6, from 7 and 8

OR

Double click button 4 will flash indicator light twice, and rotate the dial to activate the functions 5 and 6

## TO RECHARGE THE REMOTE

Remote can be recharged using the C type port given at the backside of the dial. Follow the steps to recharge the remote.

1 Remove the dial from the body by gently sliding to the top



2 Connect a C-type charger to the port for 1.5hrs to fully charge



3 A Red colored LED indication near the charging port will help to identify the charging status

4 When fully charged, the Red LED will turn in to Green

5 Check and align the snap lock and gently slide the dial back to the body by pushing down

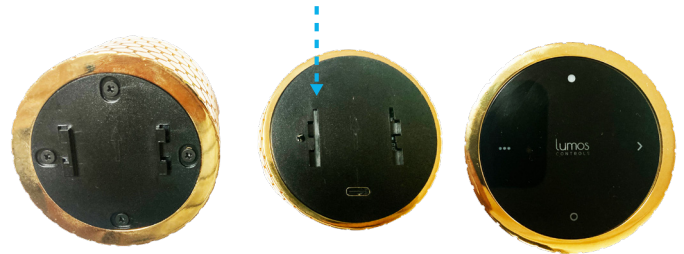

## TROUBLESHOOTING

Light doesn't turn ON immediately after operation	Check whether you have set up a transition time
The linked device does not respond to wireless messages	<ul style="list-style-type: none"> <li>• Check if appropriate devices are linked</li> <li>• Check for environment or range issues</li> </ul>

## COMMISSIONING

Once powered up, the device will be ready to be commissioned via the Lumos Controls mobile app, available for free download on [iOS](#) and [Android](#). To begin commissioning, click the '+' icon from the top of the 'Devices' tab. The app allows you to preset certain configurations which will be loaded after the device is added. The pre-configurations made using 'Commissioning Settings' will be sent to the devices being commissioned.

Once commissioned, the device will be displayed in the 'Devices' tab'.



Please visit [Help center](#) for more details

## WARRANTY

5-year limited warranty

Please find warranty [terms and conditions](#)

Note: Specifications may change without notice

Actual performance can vary due to end-user environment and application

## LUMOS CONTROLS APPLICATION

Download the 'Lumos Controls' application from Play Store or App Store  
OR

Scan the QR codes to download the 'Lumos Controls' application



The Bluetooth® word mark and logos are registered trademarks owned by Bluetooth SIG, Inc. and any use of such marks by WiSilica Inc. is under license. Other trademarks and trade names are those of their respective owners.