



Iris E

Edge Gateway



Product overview

Lumos Controls Iris E facilitates the data flow between multiple Lumos controls BLE mesh networks and a BMS. It helps to set up two-way communication between the BMS and Lumos controls mesh networks. This enables Lumos Controls devices to respond to commands from the BMS system and BMS components like HVAC to respond to triggers from Lumos Controls sensors

Specifications

Electrical

Specifications	Value
Input voltage	5VDC
Input current	3A

Mechanical

Specifications	Value	Remarks
Dimensions	3.93 x 3.25 x 1.28in (100 x 82.7 x 32.5mm)	L x W x H
Net weight	143gm(5.04oz)	
Case material	SS	

Environmental

Specifications	Value
Operating temperature	0 to 50°C (32 to 122°F)
Case temperature	50°C (122°F)
Relative humidity	20-90%

Features

- Supports two-way communication between Lumos Controls Mesh networks and BMS
- Connects multiple Lumos Controls gateways to the BMS
- Network connectivity for Iris E can be established using Wi-Fi or ethernet
- Supports 2.4 and 5GHz Wi-Fi bands

Interface description



Ethernet LED color	Indication
Yellow	Initiating connection with network
Green	Data transfer

Light Blinking pattern

The light blinking status enables users to know the current state of the device.



Iris E State	LED pattern
Initializing	Solid ON
Configuration Mode	100ms ON 100ms OFF
Unconfigured/Invalid configuration	500ms ON 500ms OFF
Waiting for IP	1sec ON 1sec OFF
Time not configured	3sec ON 3sec OFF
Critical Error	Fast blink
Device Ready to use	5sec ON 5sec OFF

Installation

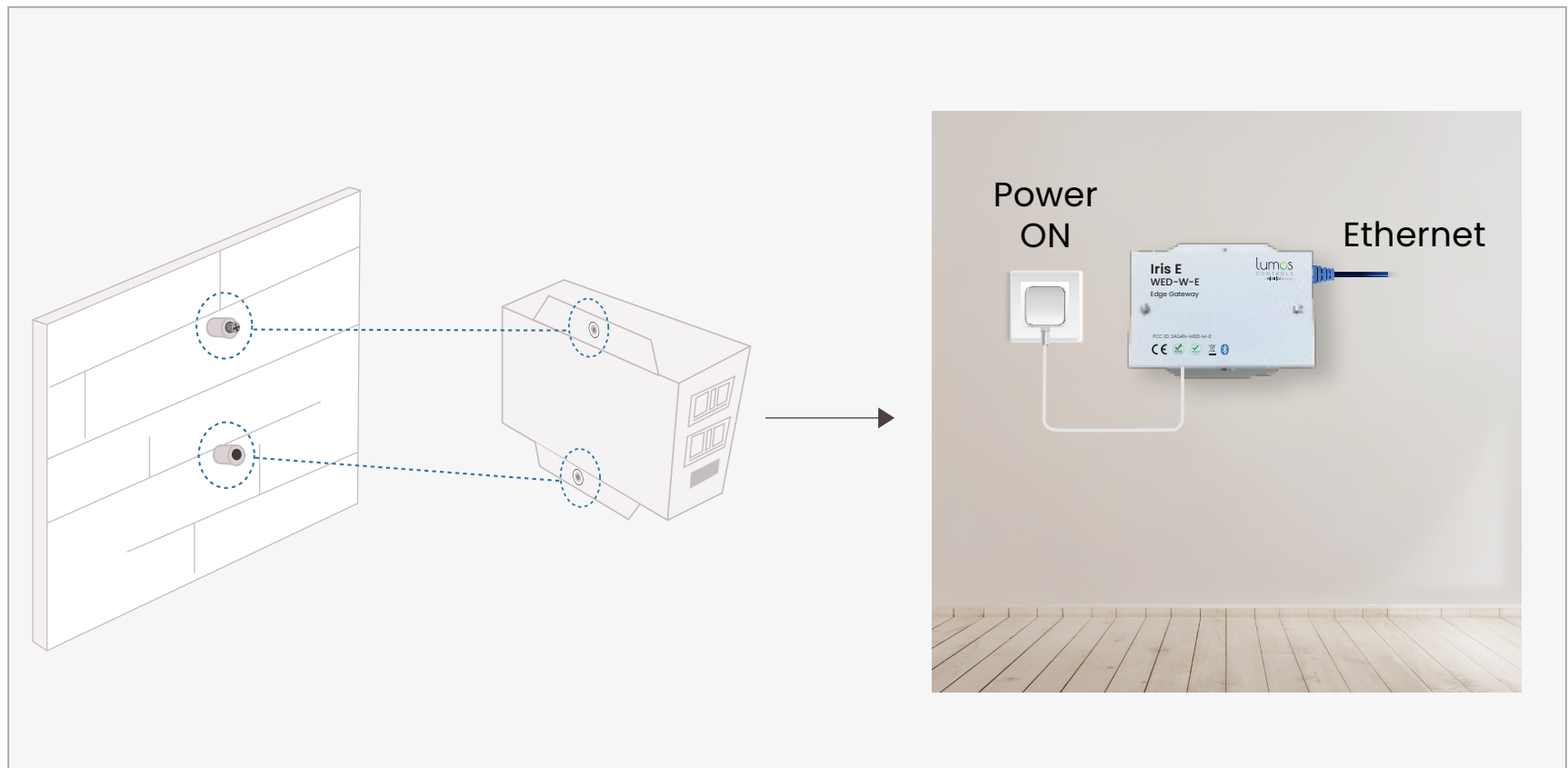

Lumos Controls BMS integration

1). For BACnet Protocols

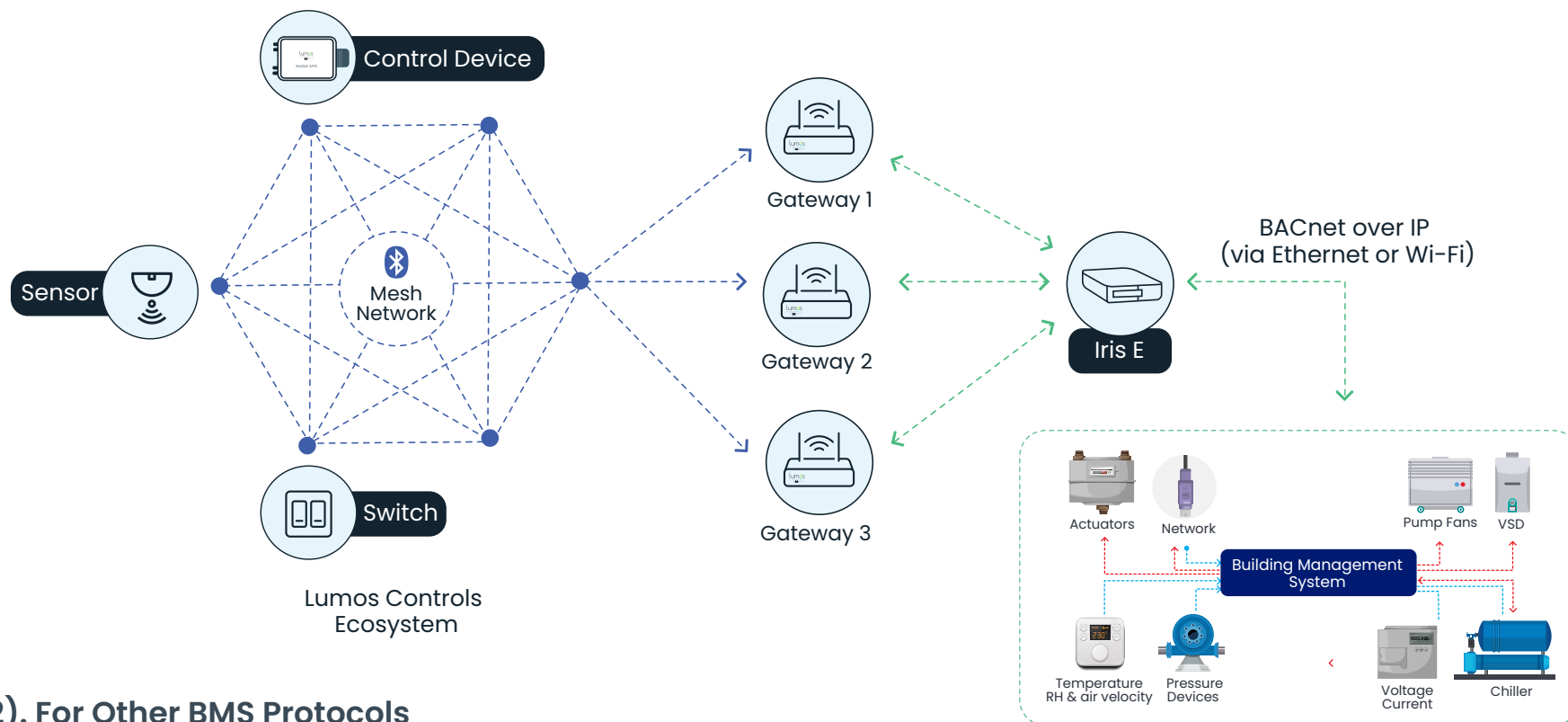

2). For Other BMS Protocols

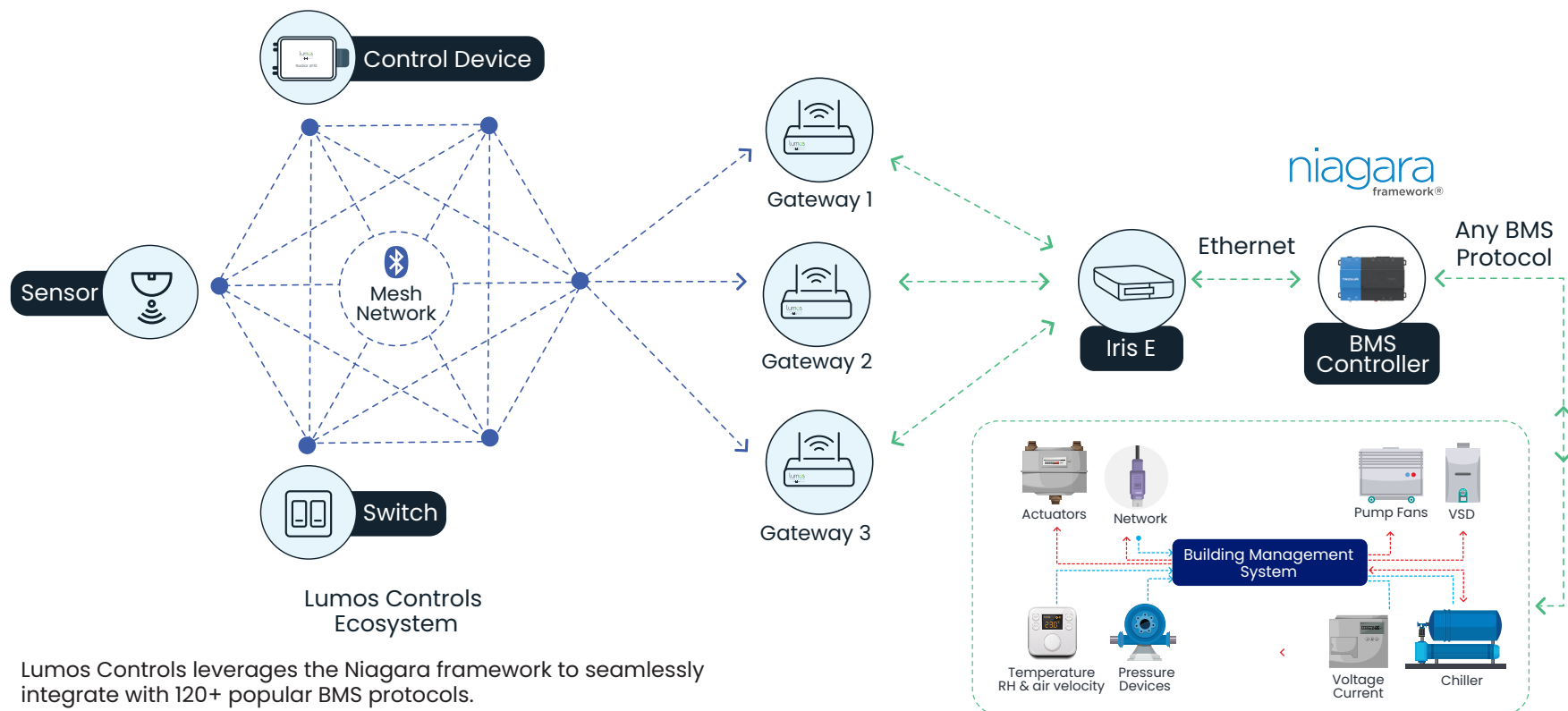

Lumos Controls leverages the Niagara framework to seamlessly integrate with 120+ popular BMS protocols.

Certifications	Details
CE	In Progress
RoHS 2.0	
REACH	
WEEE	
FCC	

Iris E application diagram

1). For BACnet Protocols

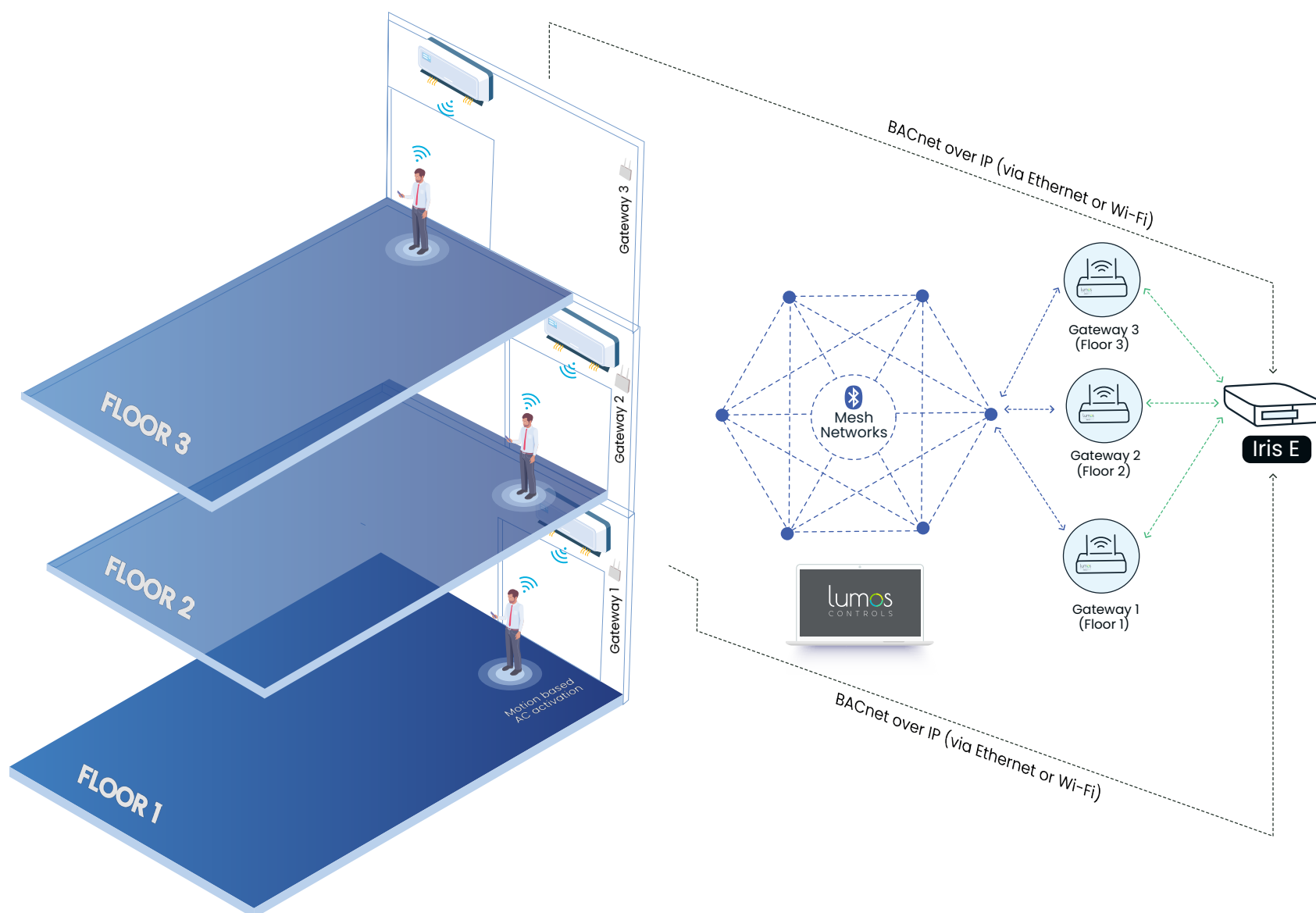

2). For Other BMS Protocols

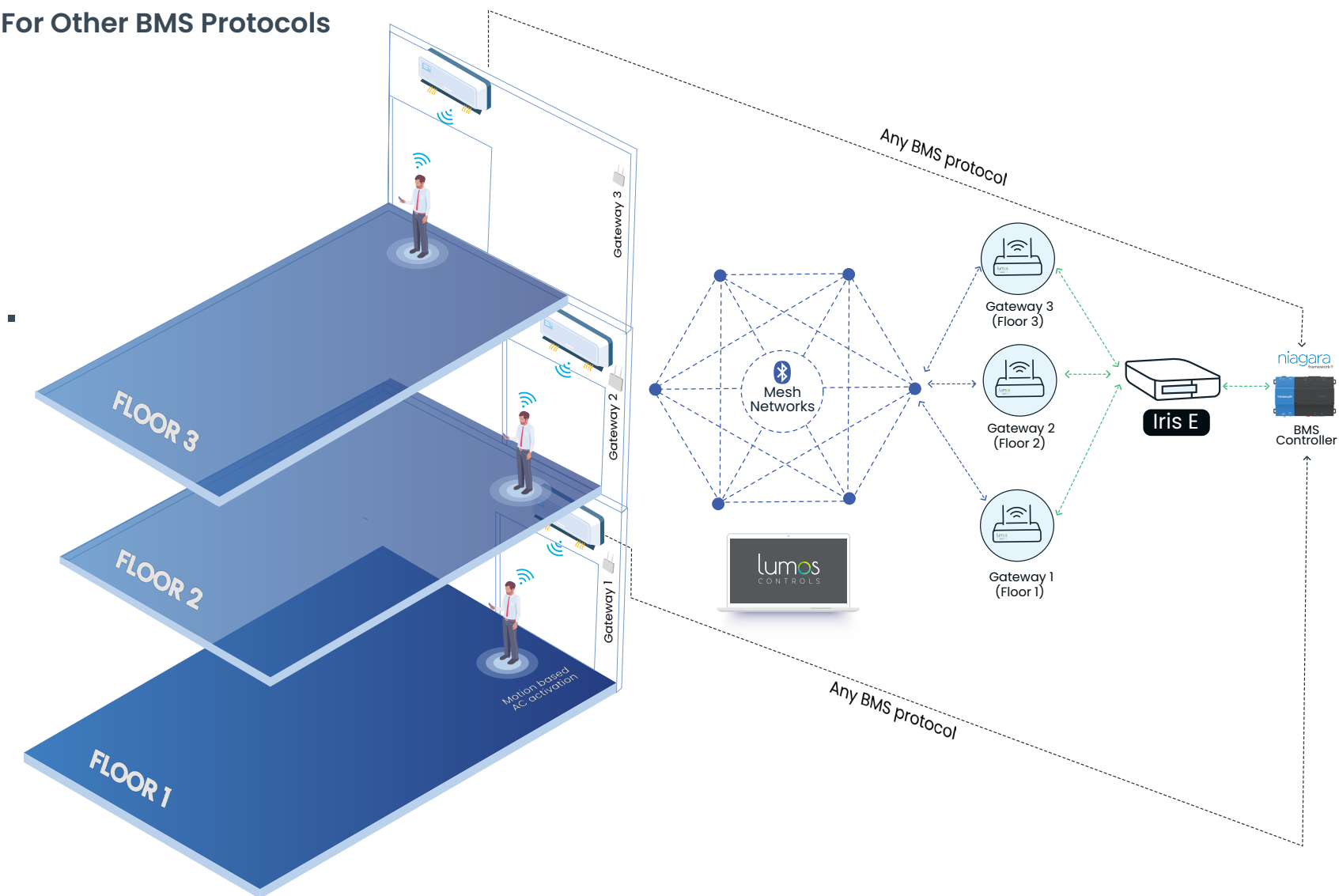

Items included in the package box

- Iris E
- User manual
- Adapter
- Screws

Ordering information

Product Code	Product Name	Product Description	Communication	Voltage Rating
WED-W-E	Iris E	Edge Gateway	WiFi or Ethernet	5VDC/3A