



SCU PANEL 220AC 8 RP

Bluetooth Smart 8 Button Panel



Product Overview

SCU PANEL 220AC 8 RP, is an AC powered 8 button switch. It has a built-in Bluetooth module that enables it to communicate with other devices in the mesh network. It can be custom configured using Lumos Controls mobile app to control the brightness, color temperature of the light source and invoke scene through buttons.

The Lumos Controls ecosystem comprises controllers, sensors, switches, modules, drivers, gateways, and analytical dashboards. The ecosystem is listed by the **Design Lights Consortium (DLC)**, qualifying it for energy conservation incentive programs and rebates by utility companies.

Specifications

Electrical

Specifications	Value
Input voltage	100-240VAC
Frequency	50-60Hz
Standby power consumption	<2W

Bluetooth

Specifications	Value
Frequency range	2402-2480MHz
Transmit power	8dBm
Accept power	-95dBm

Features

- 8 button any point configuration function
- Simple and classic sophisticated look
- Personalized engraving service
- Distributed network communication based on BLE 5.2
- Zero downtime Over-the-Air firmware update
- Match the number of intelligent products to form a more perfect intelligent network web, mobile or tablet app control

Environmental

Specifications	Value
Operating temperature	-5 to 45°C (23 to 113°F)
Storage temperature	-20 to 70°C (-4 to 158°F)
Storage humidity	20% to 95%

Mechanical

Specifications	Value	Remarks
Weight	114g(4.02oz)	
Dimension	86x86x40.4mm (3.38 x 3.38 x 1.59in)	L x W x H

Product Dimensions

Front Panel

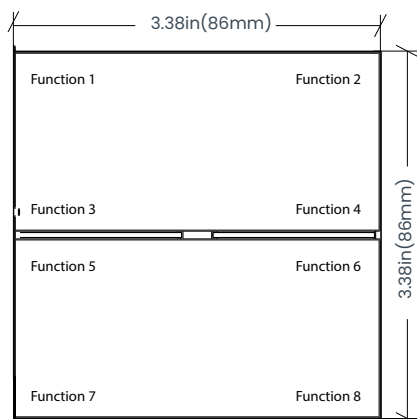

Panel side

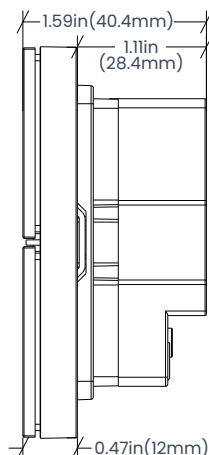

Back of the panel

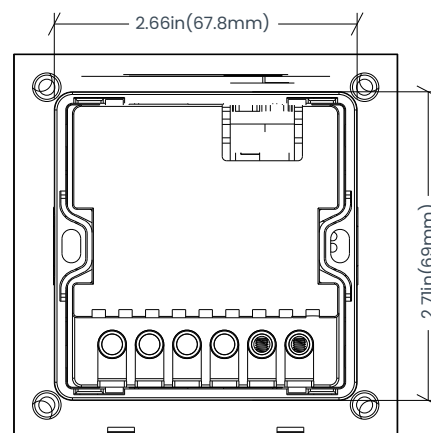

Wiring Diagram

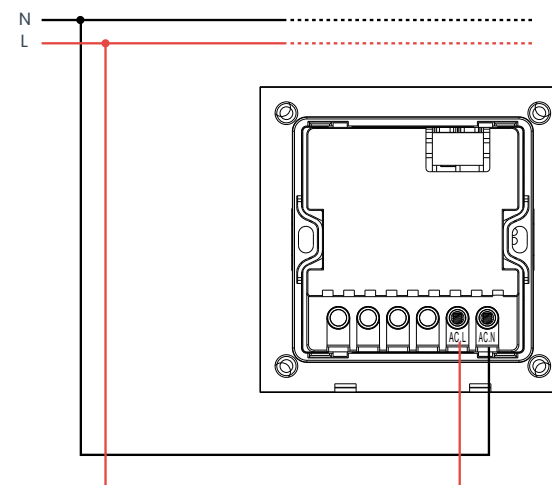

Installation Steps

- 1 Turn power OFF at circuit breaker and ensure the power is OFF before wiring.
- 2 Fix the wall frame to the surface of the switch box using screws
- 3 Take out the line and neutral wires from the switch box
- 4 Connect these line and neutral wires to the line and neutral connectors on the backside of the AC switch
- 5 Ensure the switch is correctly positioned and push it into the face plate for fitment
- 6 Restore power to the circuit breaker
- 7 Now commission and configure the switch using Lumos Controls mobile application

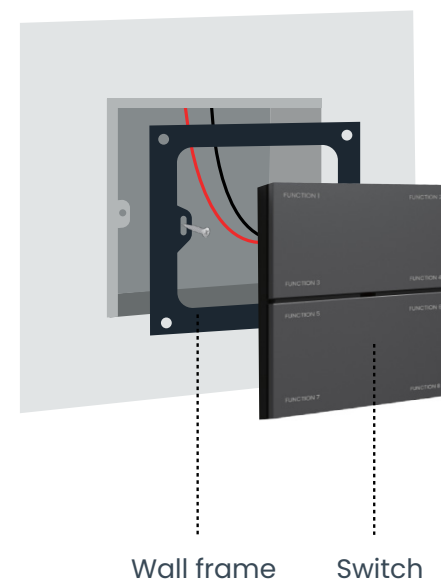

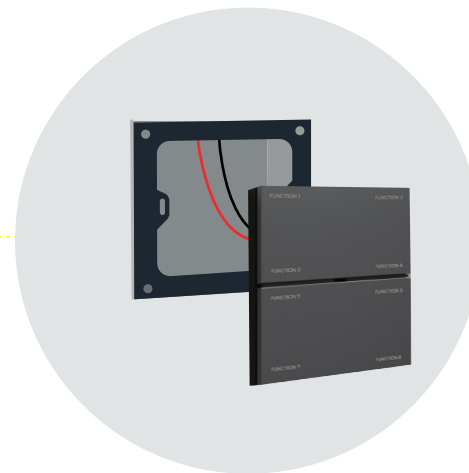

Smart Ecosystem

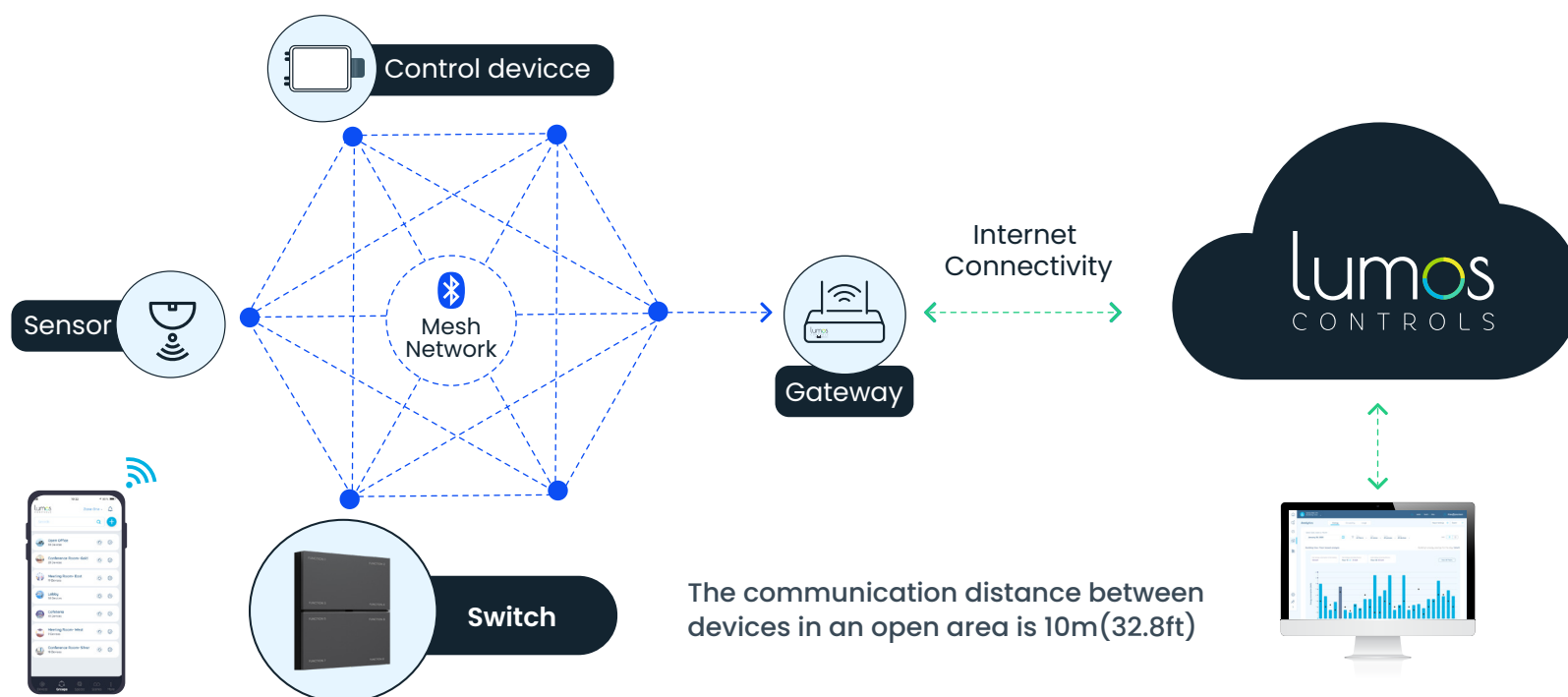

Application

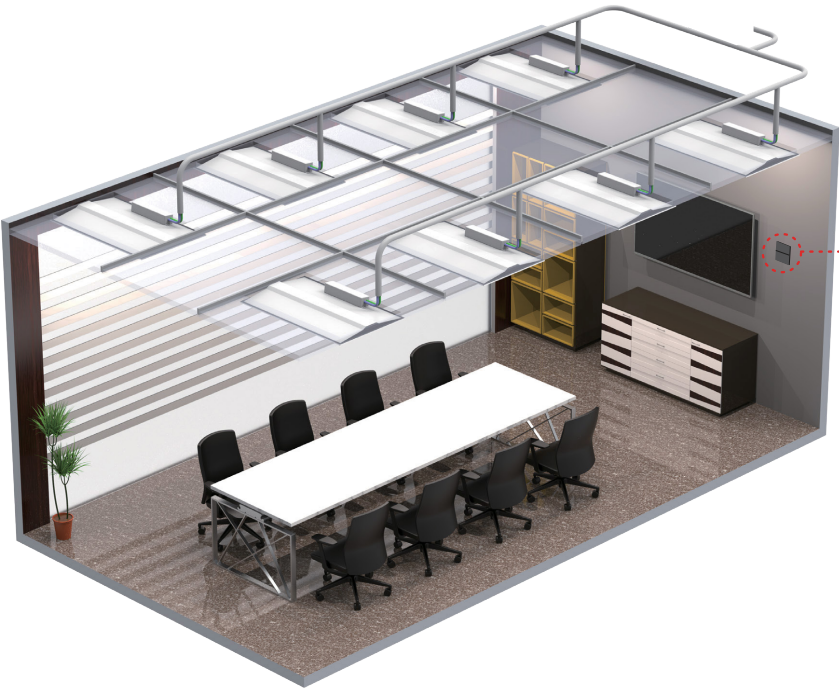

SCU PANEL 220AC 8 RP



Ordering Information

Product Name	Product Code	Product Description	Communication	Finish	Color
SCU PANEL 220AC 8 RP	WSAP8BFMBK	Wireless AC-Powered 8 Button Switch	BLE5.2	Full Metal	● Black
	WSAP8BFMSGY				● Sumatra Gray
	WSAP8BFMGL				● Gold
	WSAP8BFMDGY				● Deep Gray
	WSAP8BFMS				● Scarlet
	WSAP8BFMMCBK			Full Metal With Mirror Coating	● Black
	WSAP8BFMMCGL				● Gold
	WSAP8BFMMCGL				● Gray
	WSAP8BFMMCGL				● Gray

The Bluetooth® word mark and logos are registered trademarks owned by Bluetooth SIG, Inc. and any use of such marks by WiSilica Inc. is under license. Other trademarks and trade names are those of their respective owners.



20321 Lake Forest Dr D6,
Lake Forest, CA 92630

 www.lumoscontrols.com
 +1 949-397-9330