



# PSC-DM-WS-100-BLE-WS

1-Button Bluetooth Mesh Wall Controller



# PRODUCT OVERVIEW

PSC-DM-WS-100-BLE-WS wirelessly communicates with other Bluetooth mesh network devices to provide scene and light level control to lighting in the space. It can be installed in a standard 1-gang wall box.

PSC-DM-WS-100-BLE-WS is a part of Lumos Controls ecosystem supported by controllers, sensors, switches, modules, drivers, gateways, and analytical dashboards. The ecosystem is listed by the **Design Lights Consortium (DLC)**, qualifying it for energy conservation incentive programs and rebates by utility companies

# SPECIFICATIONS

## Electrical

Specifications	Value	Remarks
Input voltage	120-277 VAC	@ 50/60Hz
Power consumption	Max 1.5W	

## Bluetooth

Specifications	Value	Remarks
Frequency range	2402-2480MHz	
Max output power	8dBm	Conductive
Receive sensitivity	-95dBm	
Connection distance (device to device)	45m(147.6ft)	Vary depending on the installation environment

# FEATURES

- BLE 5.2 based non-flooding intelligent communication
- Manual ON/OFF (wireless)
- Dim UP/DOWN (wireless)
- Conforms with DLC NLC5 Cybersecurity Standards
- LED status indicator light
- Mounts in any standard wall box

## Environmental

Specifications	Value	Remarks
Operating temperature	0° to 55°C (32 to 131°F)	
Storage temperature	-10° to 60°C (14 to 140°F )	
Relative humidity	90-95%	non-condensing at 30°C

## Mechanical

Specifications	Value	Remarks
Dimension	104.33 X 43.69 X 29.46mm (4.11 X 1.72 X 1.16in)	Length x Breadth x Height

# PRODUCT DIMENSIONS

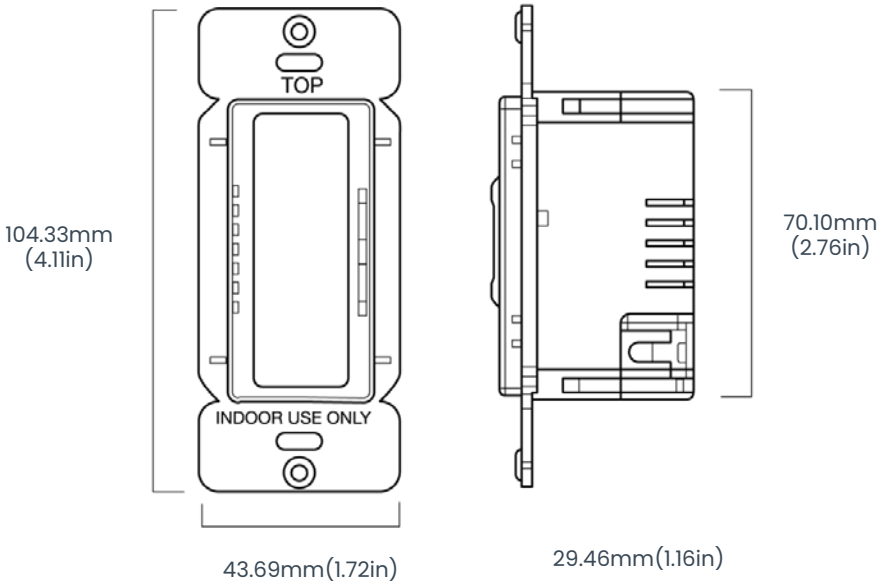

# WIRING

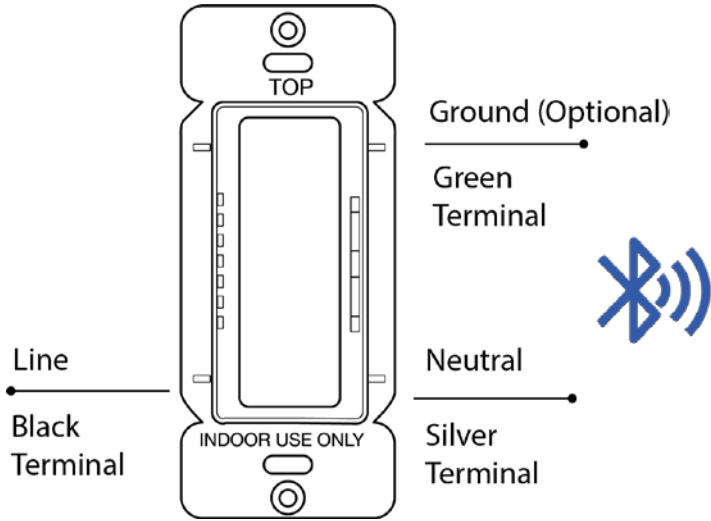

# SWITCH INTEGRATION

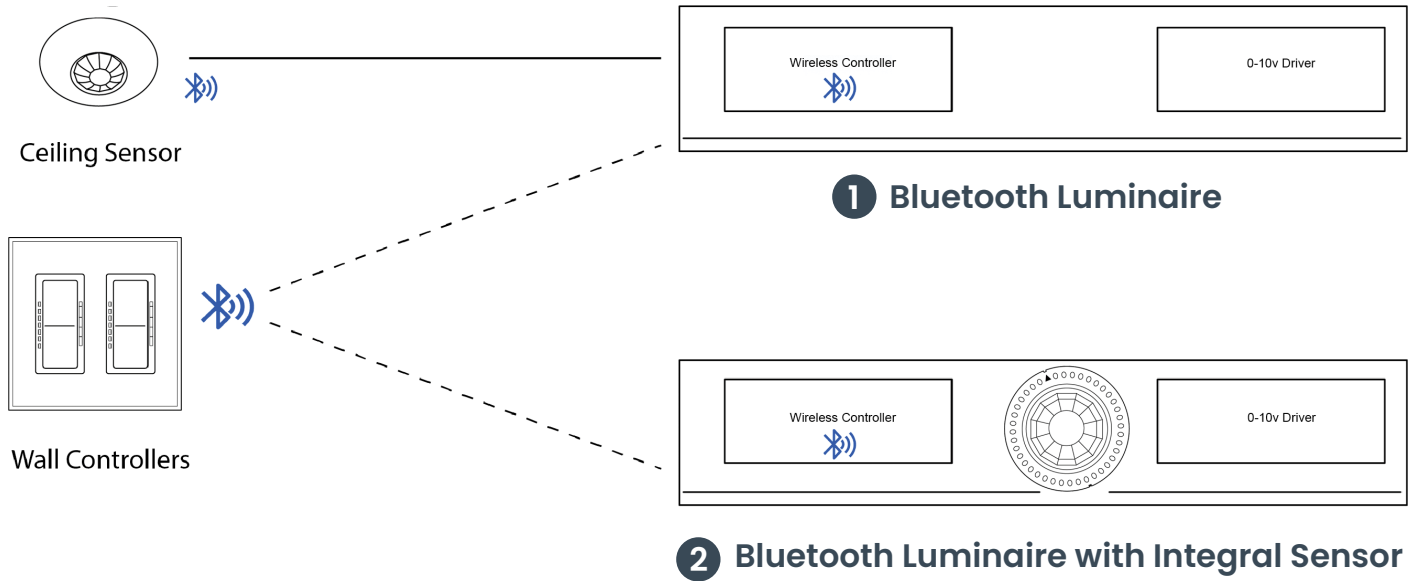

## DEVICE CONTROLS

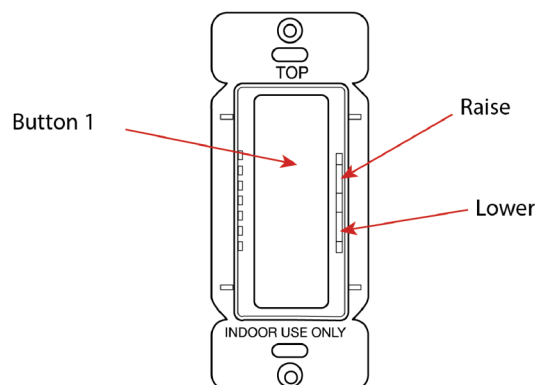

### BUTTON 1 FOR ON/OFF:

Short press: OFF

Short press: AUTO/ON

Auto = Resume automatic control; turns on the automatic settings for luminaires (defined by the settings profile).

### COMMISSIONING MODE:

Press and hold Button 1 together with side toggle at top and bottom for 10 sec to bring the switch in to commissioning mode.

### FOR DIMMING:

Raise Toggle

Lower Toggle

## SMART ECOSYSTEM

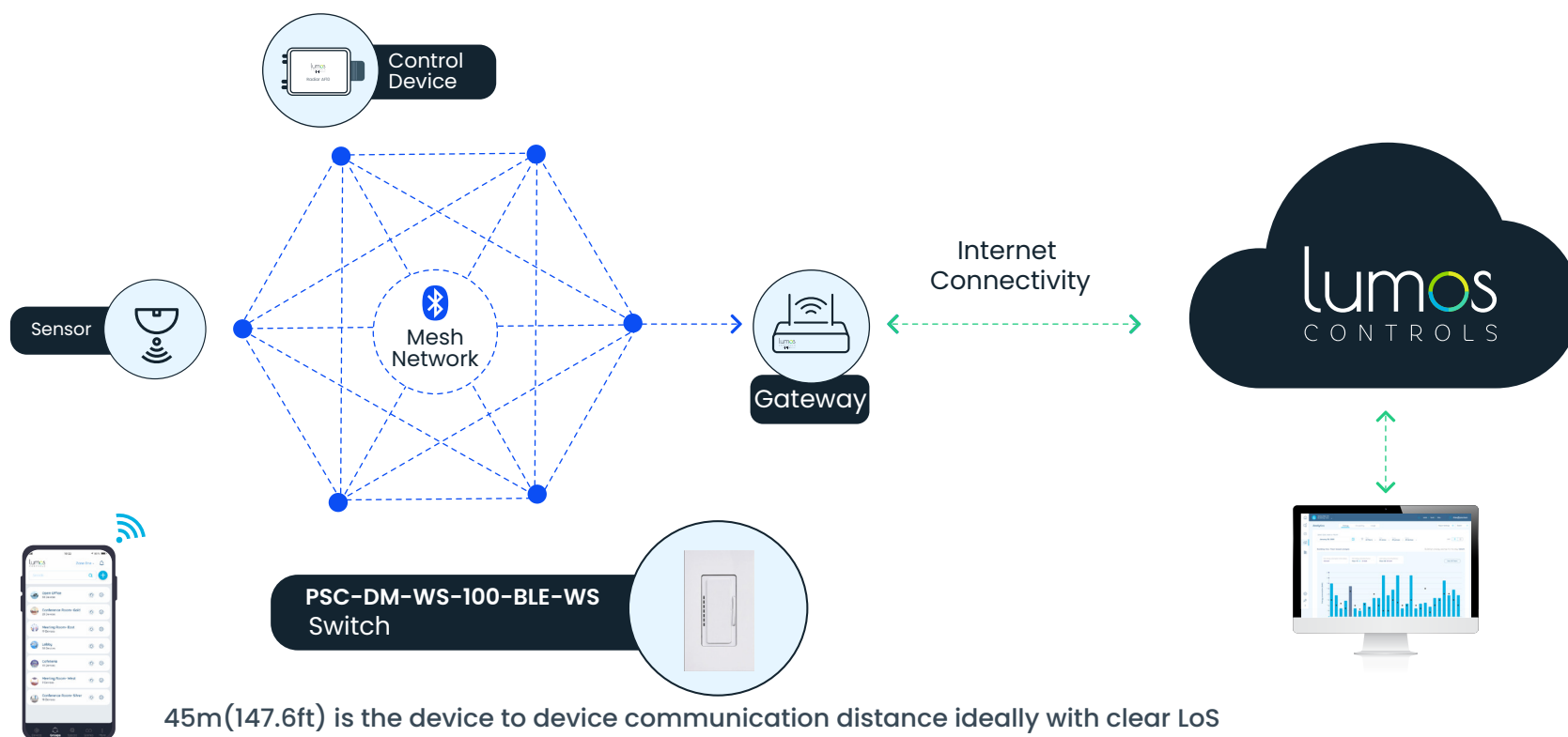

# APPLICATION

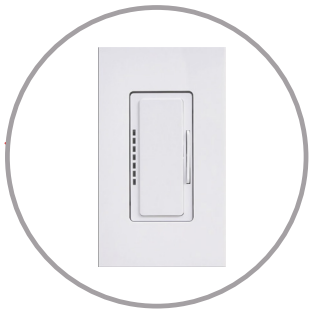
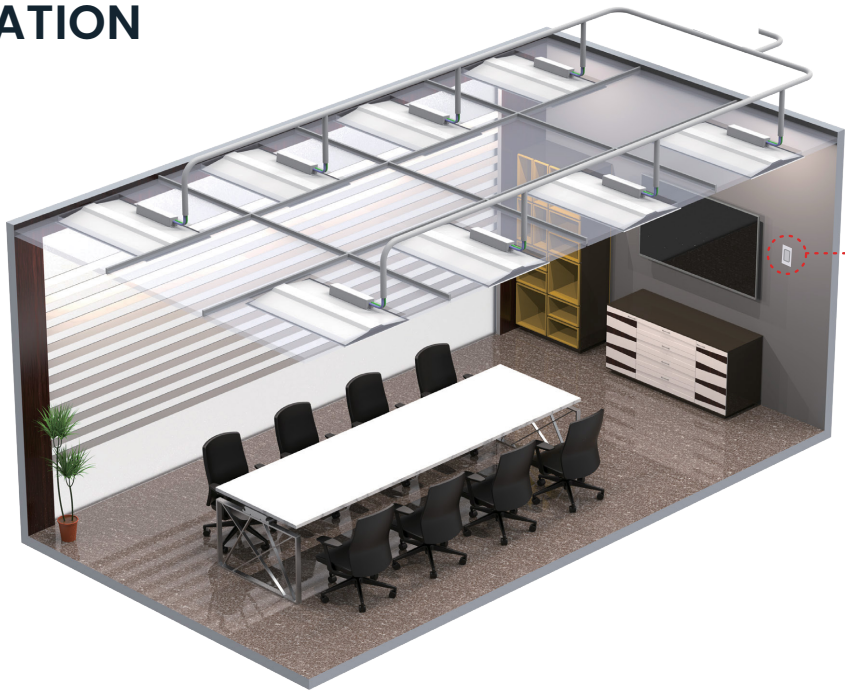

PSC-DM-WS-100-BLE-WS

# ITEMS INCLUDED IN THE PACKAGE BOX

- PSC-DM-WS-100-BLE-WS
- User guide
- Screws



# ORDERING INFORMATION

Product Code	Product Description	Communication	Voltage Rating	Functionality
PSC-DM-WS-100-BLE-WS	1-Button Bluetooth Mesh Wall Controller	BLE5.2	120-277VAC	ON/OFF, Dimming

The Bluetooth® word mark and logos are registered trademarks owned by Bluetooth SIG, Inc. and any use of such marks by WiSilica Inc. is under license. Other trademarks and trade names are those of their respective owners.



20321 Lake Forest Dr D6,  
Lake Forest, CA 92630

 [www.lumoscontrols.com](http://www.lumoscontrols.com)  
 +1 949-397-9330